

HONDA

*3.0L & 3.5L V6

TIMING BELT APPLICATION

Application	Labor Time	Belt Part No.
3.0L V6 (J30A1)		
Accord		
1998-01	4.7 Hours	T286
3.5L V6 (J35A1)		
Odyssey		
1999-01	4.0 Hours	T286

MANUFACTURER'S SUGGESTED SCHEDULED MAINTENANCE

Normal replacement interval is at 105,000 miles or 84 months. Replace at 60,000 miles if car is regularly driven in extreme temperatures (over 110 degrees F, or under -20 degrees F).

***NOTE: The 3.0L is an interference engine. See page A-59 for interference engine cautions.**

REMOVAL & INSTALLATION

TIMING BELT

Removal:

- Disconnect negative battery cable. Turn crankshaft pulley so that No. 1 piston is at TDC on compression stroke. White mark on crankshaft pulley should align with pointer on front cover. Remove lower engine splash shield. Remove the generator and power steering pump drive belts.
- Remove dipstick tube from front of engine. Support engine with a jack, and remove engine side mount from front of engine. Remove crankshaft pulley.
- Remove upper and lower timing belt covers. See Fig. 1. If reusing timing belt, mark direction of belt rotation for installation reference.
- Remove one of the battery clamp bolts from battery tray. Grind threaded end of bolt to a partial point (about 45 degree chamfer). Thread battery bolt into rear cover to hold timing belt adjuster in installed position. Hand tighten ONLY. See Fig. 2.

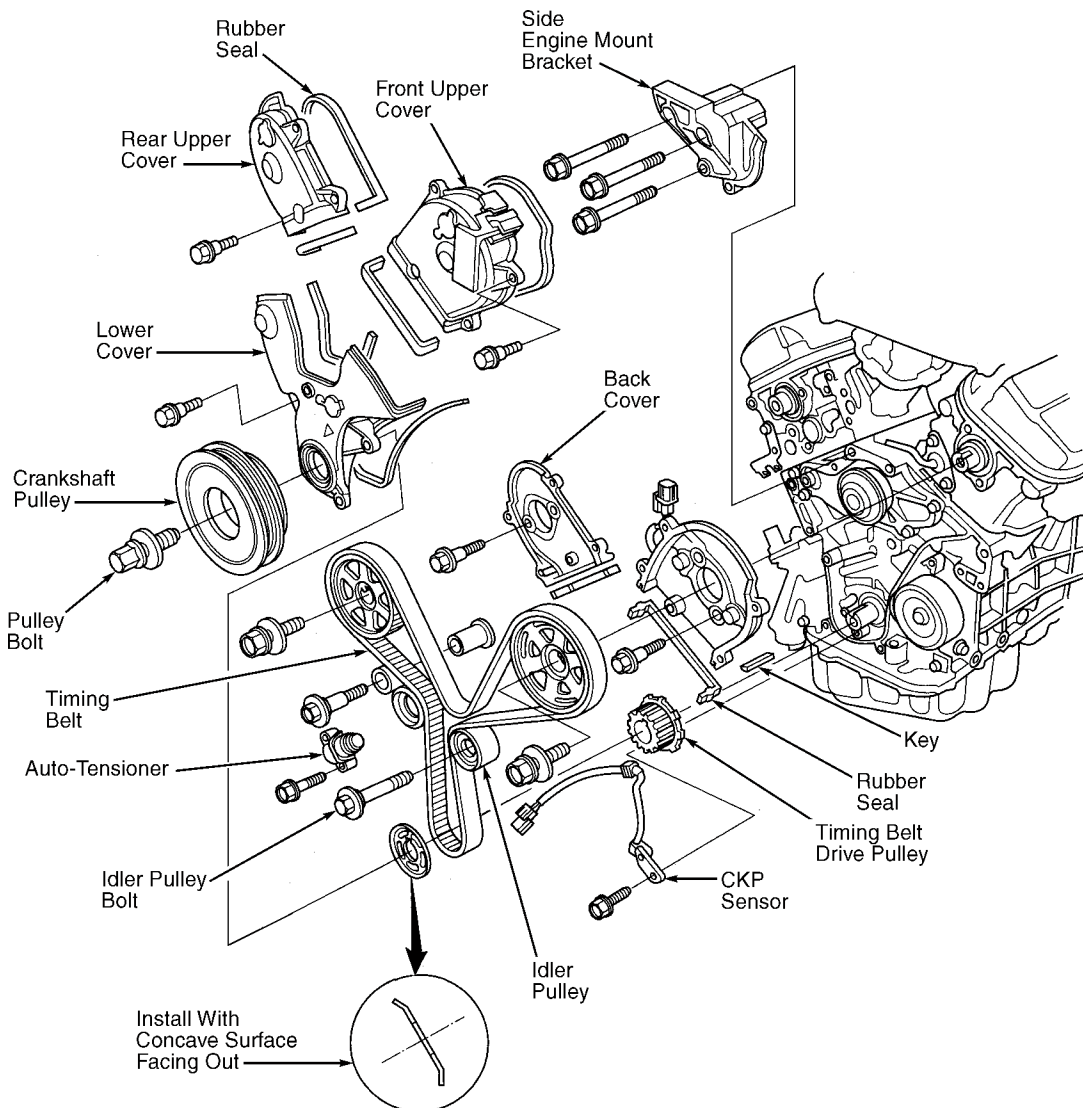

97D11679

Courtesy of American Honda Motor Co.

Fig. 1: Exploded View Of Timing Belt Components

HONDA

*3.0L & 3.5L V6 (Cont.)

289

- Remove side engine mount bracket from front of engine (above water pump pulley). Loosen timing belt idler pulley bolt 5-6 turns. Remove timing belt.

Installation:

- Ensure that engine is at TDC. Align dimple on timing belt drive pulley with pointer on oil pump. See Fig. 3. Align camshaft pulleys with pointers on back covers.

CAUTION: Handle auto-tensioner carefully so oil does not spill or leak out. Replace any oil that may leak out.

- Remove battery clamp bolt from back cover. Remove the timing belt auto-tensioner.
- For auto-tensioner with removeable bolt, hold auto-tensioner with maintenance bolt pointing up. Remove maintenance bolt. See Fig. 4. Clamp auto-tensioner in soft-jawed vise. DO NOT grip auto-tensioner housing. Insert flat blade screwdriver into maintenance hole. Place stopper on auto-tensioner while turning screwdriver clockwise to compress tensioner to bottom.
- Replace any oil that may have spilled out of auto-tensioner. Reinstall maintenance bolt with NEW gasket. Ensure no oil is leaking around maintenance bolt, then reinstall auto-tensioner onto engine with stopper in place.
- On 2000-01 models with sealed auto-tensioner, place tensioner in press. SLOWLY compress tensioner until pin can be inserted through tensioner body and insert pin. See Fig. 5. Install auto-tensioner onto engine.
- On all models, install timing belt in following sequence: Crankshaft pulley, idler pulley, front camshaft pulley, water pump pulley, rear camshaft pulley and tension adjust pulley. See Fig. 6. Ensure crankshaft and camshaft pulleys remained aligned with marks on back cover. Tighten idler pulley bolt.
- Remove stopper or pin from auto-tensioner. Install engine side mount bracket to the front of engine (above water pump pulley). Install upper and lower covers. Install crankshaft pulley. Lubricate crankshaft pulley bolt threads and install bolt. Tighten crankshaft pulley bolt to specification. See TORQUE SPECIFICATIONS.
- Rotate crankshaft about 5-6 turns clockwise to position timing belt on pulleys. Ensure crankshaft and camshaft pulleys are aligned at TDC. Crankshaft pulley White mark should be aligned with pointer on front cover. Remove rubber plugs from upper covers to check camshaft pulley positions.
- If either camshaft is not at TDC, remove timing belt and readjust position. To complete installation, reverse removal procedure. Tighten all fasteners to specification. See TORQUE SPECIFICATIONS. Adjust drive belts to proper tension. See page A-60 for belt tension ranges.

TORQUE SPECIFICATIONS

Application	Ft. Lbs. (N.m)
Camshaft Sprocket Center Bolt	67 (90)
Crankshaft Pulley Bolt	181 (245)
Engine Side Mount Bracket-To-Mount Through-Bolt	
Accord & Odyssey	40 (54)
Engine Side Mount-To-Engine Bolts	33 (44)
Idler Pulley Bolt	33 (44)
Power Steering Pump Lock Nut	17 (24)
Power Steering Pump Mount Bolt	17 (24)
	INCH Lbs. (N.m)
Auto-Tensioner Maintenance Bolt	71 (8)
Auto-Tensioner Mount Bolts	106 (12)
Lower Engine Splash Shield Bolts	106 (12)
Timing Belt Cover Bolts	106 (12)
Water Pump Bolts	106 (12)

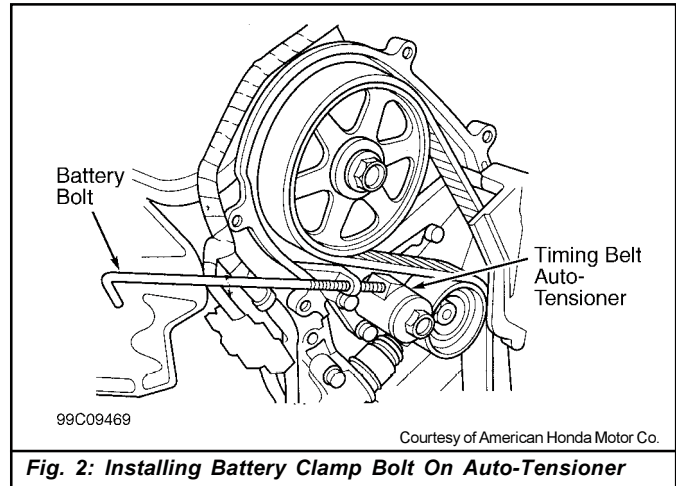

Fig. 2: Installing Battery Clamp Bolt On Auto-Tensioner

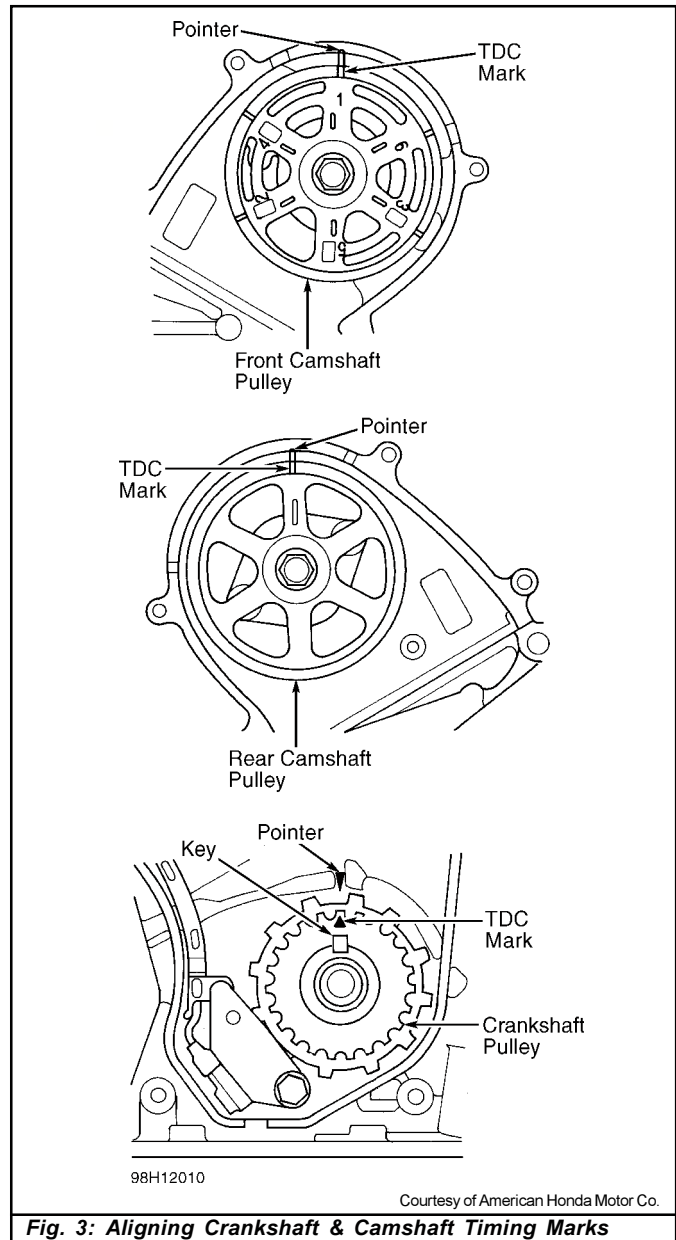

Fig. 3: Aligning Crankshaft & Camshaft Timing Marks

HONDA

*3.0L & 3.5L V6 (Cont.)

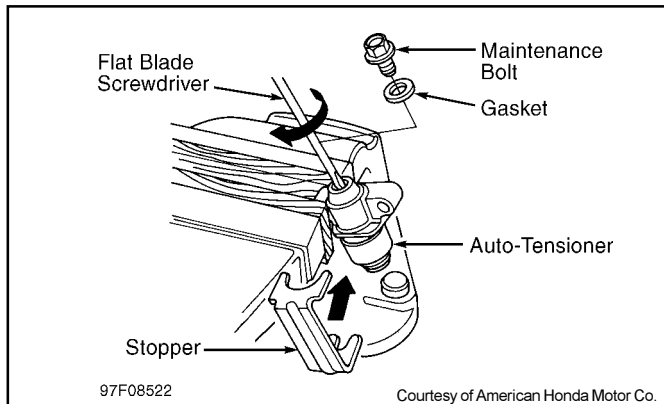

Fig. 4: Compressing Auto-Tensioner
(Accord; 1999 Odyssey)

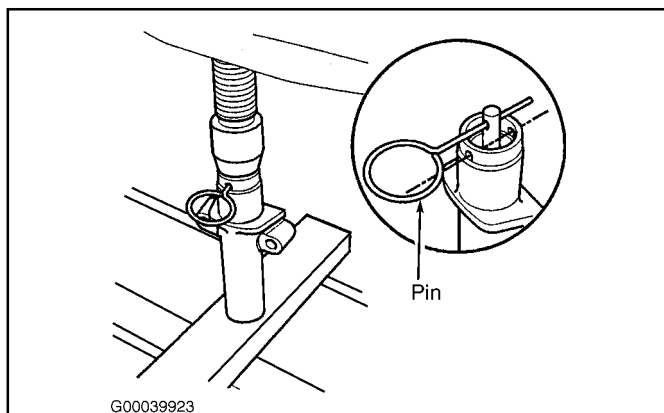

Fig. 5: Compressing Auto-Tensioner (2000-01 Odyssey)

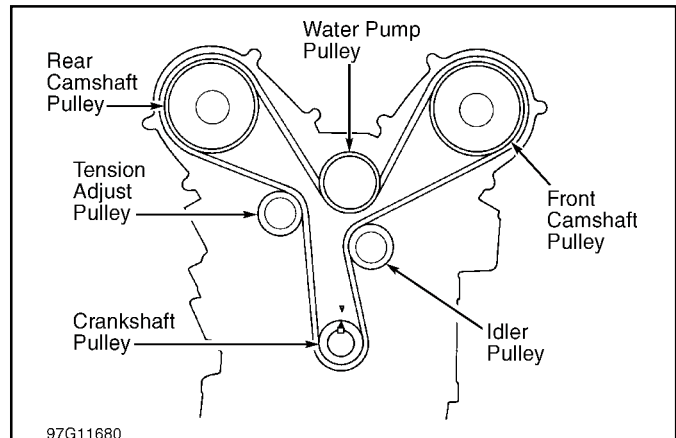

Fig. 6: Installing Timing Belt